



World leader in vehicle  
de-pollution technology



## SEDA ELV All-In-One Solution



Efficiency, safety and ergonomics are keywords in today's recycling companies. For this reason, SEDA has developed an All-In-One Solution together with car manufacturers and dismantlers. This solution is the first complete system for ELV de-pollution and dismantling which now can be performed on a new special TiltLift by one person independently.



### Your benefits:

- ✓ Parts removal and drainage all-in-one
- ✓ No further transfers necessary
- ✓ High ergonomics through optimum working heights and ideally positioned tools
- ✓ Maximum efficiency
- ✓ Optimal use of space
- ✓ Increases safety by reducing forklift traffic



#### TECHNICAL DETAILS

Lifting height:	up to 1850 mm
Max. tilting angle:	70 °
Loading capacity:	3.500 kg
Drainage and full dismantling time:	under approx. 3 hours
Space requirement:	9 x 5 x 4,5 m

#### ORDER INFORMATION

<b>N-527513-H</b>	SEDA TL-2 1800 Overfloor
<b>N-527512-H</b>	SEDA TL-1 1800 Underfloor
<b>N-527516</b>	SEDA All-In-One Support
<b>A-51048</b>	SEDA DrainTower Single
<b>P-527486</b>	Trolley RS-TL



### SEDA-Environmental LLC.

135 Walter Way  
Fayetteville, GA 30214, USA

**P:** +1 770-681-0474  
**F:** +1 800-991-7332  
**E:** [info@seda-usa.com](mailto:info@seda-usa.com)  
**W:** [www.seda-usa.com](http://www.seda-usa.com)



## All-In-One Solution

## Flow chart

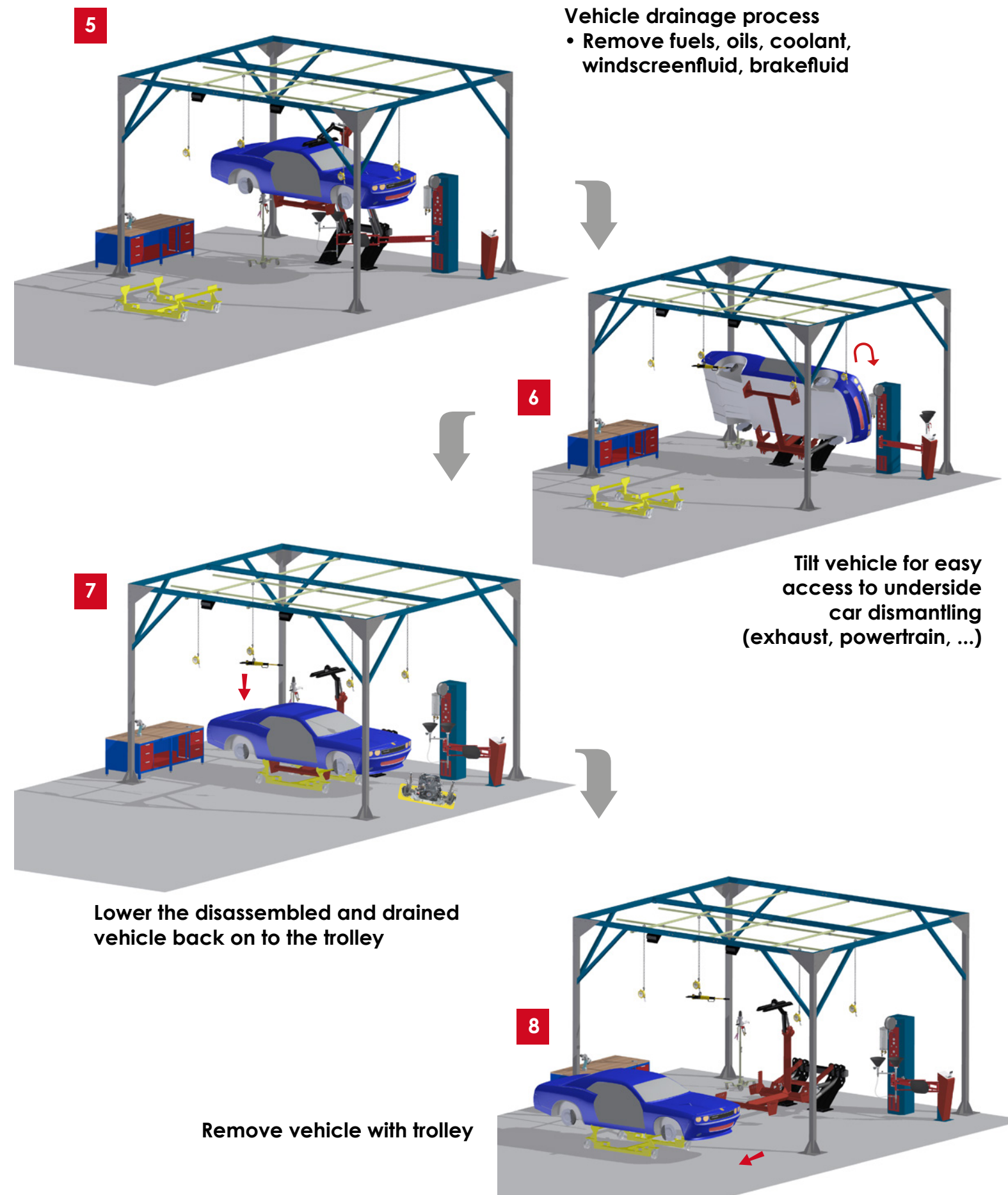
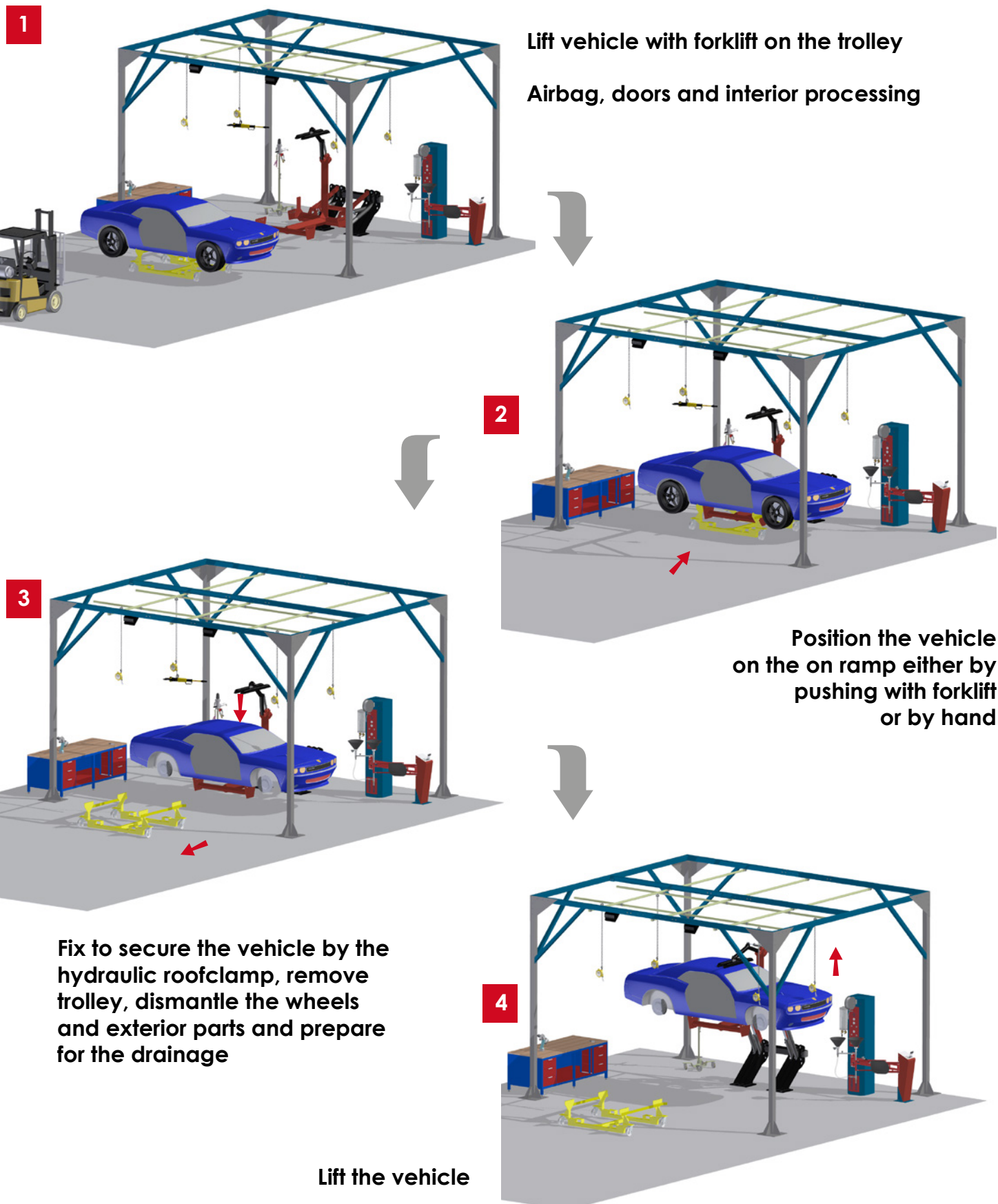

Congratulations, now you successfully drained and dismantled an ELV within 3 hours!



## Possible expansion stages

- Roll-up door extension
  - Tarpaulin sides
    - Panels
      - Roof
        - Conveyor belts ...



*Example*

***The system can be adapted on individual wishes and requirements by the customer.***